

BENSON POLYTECHNIC HIGH SCHOOL

DESIGN ADVISORY GROUP SESSION #4

SUMMARY AND NOTES

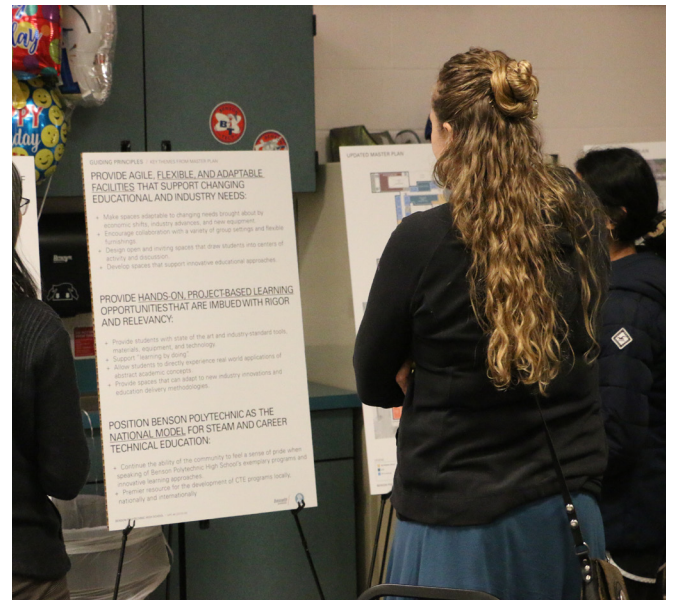
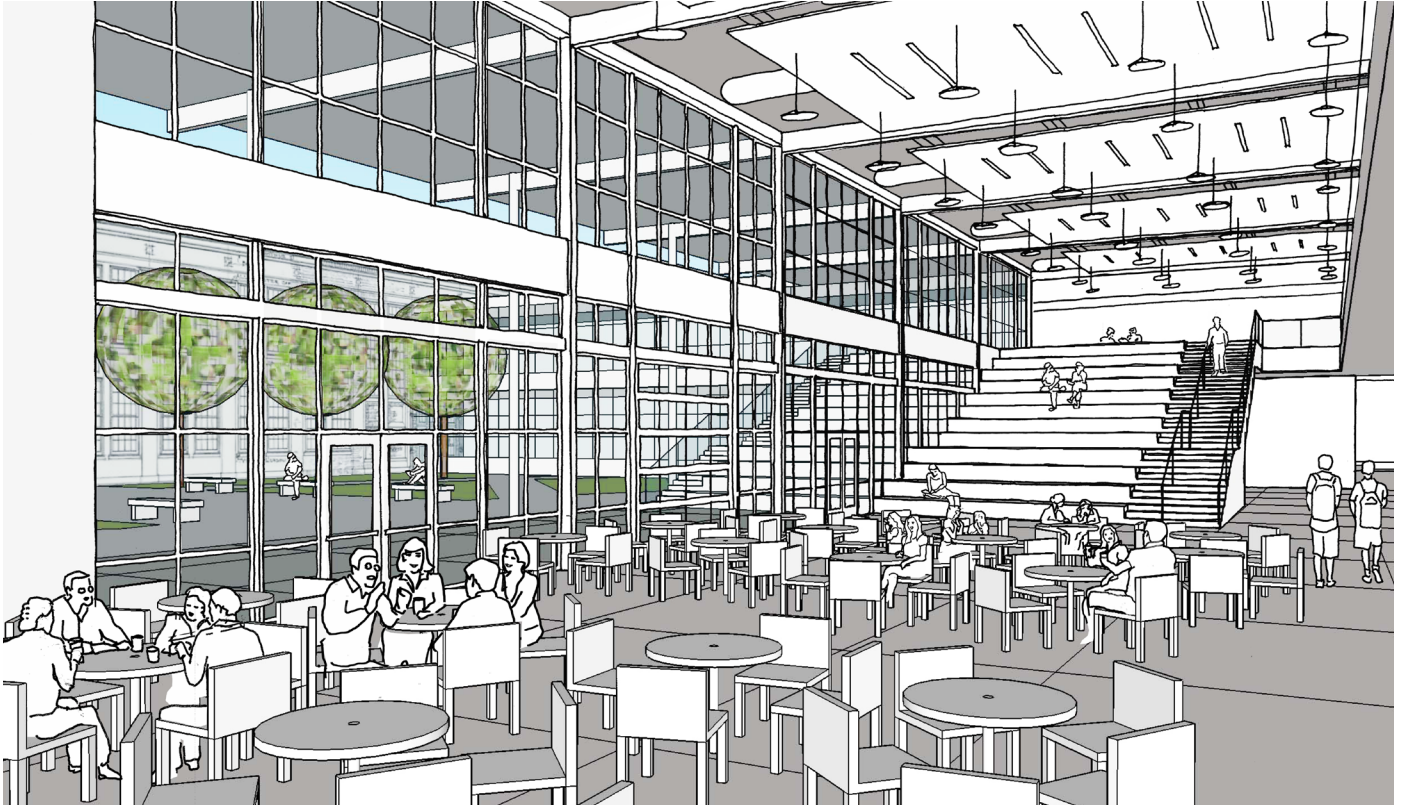

THIS PAGE INTENTIONALLY LEFT BLANK

MEETING DETAILS

Meeting Location

Benson Polytechnic High School,
546 NE 12th Ave, Portland, OR 97232

Attendees

PORTLAND PUBLIC SCHOOLS (PPS):

Jen Sohm, Design Project Manager
Jeanne Yerkovich, Director of Career Technical Education
Jamie Hurd, PPS Project Manager

DESIGN ADVISORY GROUP MEMBERS IN ATTENDANCE:

Curtis Wilson Jr., Principal
Paul Anthony, Board of Education
Glen Pak, DAG Co-Chair
Roi San Anderson
Brian Gerber
Amy Henry
Tammy Hite
Luke Hotchkiss
Dave Ketah
Bryan Smith
Todd Williams

Janice Choy-Weber
Kevin Clark
Jean DeCastro
Brent Dahl
Angel Dawson
Wendy Farber
Marlene Gillis
Susan Hargrave
Rob Johns
Heather Leek
Elizabeth O'Malley
Matt Pellico
Richard (Dick) Spies
Brian Unflat

Immacula Bixby
Sophia Chin
William Horner
Hazel Curley O'Malley
Griffin Jackson
Henry Kirkpatrick
James Littrell
Adrian Sanchez-Ortiz
Arlette Torres

PUBLIC

Nate Buddress, Interested Party
Henry Senters, Student

DESIGN TEAM

Lorne McConachie, Bassetti Architects
Joe Echeverri, Bassetti Architects
Aydin Eهران, Bassetti Architects
Mariko Park, Bassetti Architects
Amanda Lockwood, Bassetti Architects

Agenda

5:30 – 6:00	Arrival & Welcome
6:00 – 6:10	Subcommittee Follow-Up – Rob Johns
6:10 – 6:20	Project Tours – Grant HS Observations
6:20 – 6:30	Project Update – PPS Overview Feedback/Questions from DAG
6:30 – 7:25	Gathering Spaces Activity Activity Overview –Bassetti Architects Input Activity: Imagery and Design Progression + Commons + Flex Areas + Collaboration Zones Feedback/Questions
7:25 – 7:45	Sustainability Activity Overview Brainstorming
7:45 – 7:55	Public Comment
7:55 – 8:00	Closing Thoughts Summer DAG Scheduling

SUB-COMMITTEE FOLLOW-UP

Rob Johns - Sub-Committee Interests: Looking for champion(s) to lead sub-committees.

- + Industry outreach and opportunities
- + Support from utility companies and other industry for project support

SITE TOURS

Grant HS Observations:

- + 10 acres, lots of campus I shared with parks
- + Benson 9 acre site but building footprint is larger
- + Liked keeping "Grant as Grant"
 - + Interiors could have been more authentic instead of completely gutted feeling
 - + Washington HS not completely gutted and kept some of its character
 - + How can Benson keep its character in the interiors and find that balance of 'glimpses into past'
 - + Important to Benson community to stay connected to past
 - + Daylight and light wells 'really nice'
 - + Sunken outdoor spaces felt private from public space yet still connected to school
- + Kellogg MS
 - + Building damage and falling apart
 - + School torn down yet only 2% going to landfill, rest being re-used in new building



PROJECT UPDATE - PPS

December 18 BOE Meeting:

- + Master Plan approved at Dec Board Meeting
- + \$296 million budget approved
- + ADA access to Buckman Field included
 - + Director Anthony notes that BOE will have questions about \$ for field.

Upcoming Dates:

- + February 26th worksession for location analysis of MPG programs
- + March 19th next deadline for updates to Master Plan.



GATHERING SPACES ACTIVITY

Lorne McConachie of Bassetti Architects provided an overview of trends in 21st Century schools - focused on common areas, flexible breakout areas, and spaces that support collaboration.

DAG Member Feedback:

- + White boards and white board tables w/ no ghosting
- + Like openness but with pockets to retreat and focus (less stimulus)
- + Wall space for enclosure with balance of transparency to corridor
- + Show casework with display – High Tech High (Sand Diego, CA) with outdoor space being showcased
- + Nice break out and overflow spaces with tables for study hall, lunch, or just getting out of the classroom
- + Windows great but concerned about where to put storage (usually on perimeter of classroom)
- + Satisfied extrovert and introvert in commons because adjacent space is little nook so have ability to retreat in secure area – both can be had
- + Bump outs like at Knight Cancer Institute only for two people with white board
- + “Fish-bowl” classrooms for major okay and can have duality to be transparent or opaque
- + Whiteboards in controlled environment (maybe not in corridors to avoid unwanted drawings on them)
- + Balance openness of learning stair area with quiet spaces and edges.
- + “Fish-bowl” classroom with lots of glass can be distracting – feedback from Franklin students
- + Concerned about active shooter, place of refuge not as easy with extensive glazing into classrooms

The groups broke out for review of imagery in more detail. The following pages describe the images preferred by green dots, and comments provided.



MOST LIKED IMAGES

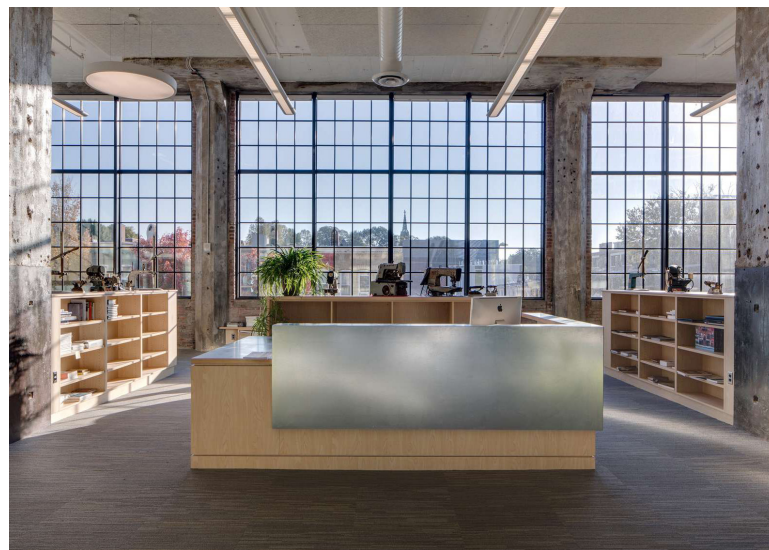

COMMENTS

- + Respect the historic shell. Expose old and new structure. Let the building tell a story of how it works. Allow room for display of projects.
- + Furniture should be modern and curved, but durable.
- + White boards, coffee tables, for relaxed, shared co-lab
- + Modular furniture
- + I like bench type seating. Soft surfaces don't clean well and damage easily.



- + I like the "Tech" look. Show off Polytechnic.
- + Great light.
- + Open spaces are nice, but we also will need some small niche areas for kids that might be overstimulated by the vast openness.

- + Use wood structure - CLT

LEAST LIKED IMAGES

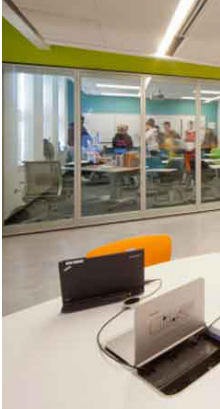

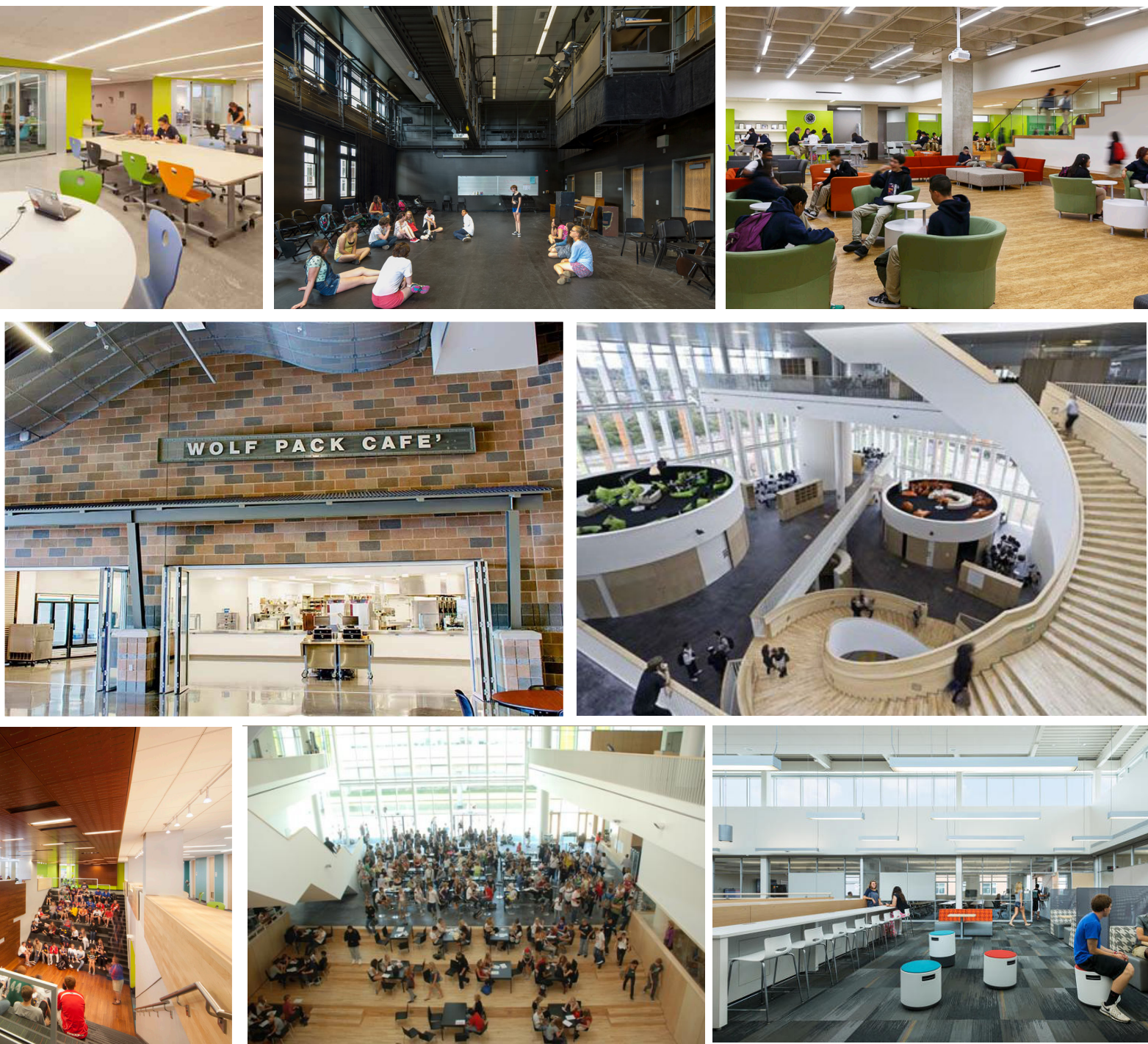

SUSTAINABILITY

Joe Echeverri of Bassetti Architects provided an overview of green building standards and certification programs. The Benson Tech Modernization will pursue LEED Certification with a minimum Silver target.

DAG Member Feedback:

- + Water on-site can be collected to avoid run-off to 12th street
- + Students aren't aware and don't know where to use recycling
- + Dedicated recycling in CTE classes for wood, metal, etc...
- + Can program re-use wood themselves, pressing saw dust into items...
- + Food waste – food made and never served b/c kids don't like all meals, maybe compost
- + Recycling decision made by District – what is the policy?
- + Awareness and education
 - + Water
 - + Material
 - + Embodied energy
 - + Design
- + Bio swales physical presence creates a teaching opportunity
- + Demonstration of wall construction as a teaching element
- + Living wall in social courtyard
- + Light shelves for classrooms/shading for controlled light
- + Grey water and green roof
- + Solar panels/wind turbines
- + Installed by students and show them how much power that is produced
- + Build infrastructure and plug & play
 - + Can PGE donate to have that accomplished?
- + Recyclable hand towels in restrooms
 - + Don't want damage done with towels, stuffing & clogging
- + PPS standard and code driven is hand blowers
- + Bicycling commuters need storage
- + Re-purposing found items/recycling
- + Combining found items into Art program

PUBLIC COMMENT

No public comments

CLOSING THOUGHTS

DAG Work sessions will be held during the summer.
Next meeting is on February 28.

